

# Freestyle™ Modular

## CANTILEVER SHELVING SYSTEM

**FREESTYLE** by  
**SPG**



ITEM # \_\_\_\_\_ MODEL # \_\_\_\_\_ QTY: \_\_\_\_

PROJECT: \_\_\_\_\_

OPTIONS:  YES \_\_\_\_\_  NO \_\_\_\_\_

### Standard Features & Benefits

- ◆ Freestanding cantilevered shelving system, no front uprights offers greater accessibility
- ◆ Increases sq.ft. and cubic volume storage capacity in existing footprint
- ◆ Adjustable shelves on 2" increments for maximum flexibility — no tools required for adjustment
- ◆ Unit is fully expandable side-to-side (Add-On Unit) using common uprights with dual-side adjustment
- ◆ Durable heavy-duty steel construction
- ◆ Shelving available in 5 widths and 8 lengths
- ◆ Uprights available in 5 heights
- ◆ Shelves, uprights, and frame kits have a durable gray epoxy-based finish with advanced antimicrobial protective agent
- ◆ Complete assortment of accessories including hanger rails and shelf covers in wire and stainless steel
- ◆ Each shelf has a load-bearing capacity of 600 lbs. with a unit rating of 1,800 lbs. for cantilevered shelves and 1,000 lbs. capacity on the bottom shelf — for a total unit capacity of 2,800 lbs.

For SPG's complete product menu,  
visit [www.spgusa.com](http://www.spgusa.com) or call 877.503.4SPG (4774)

EXPECT MORE

**SPG**  
STORAGE PRODUCTS GROUP

# Freestyle™ Modular

## SPECIFICATIONS

Begin with one of our complete Starter and Add-On Shelving Units or you can customize your system using Starter and Add-On Frame Kits, and then select your options.

<p><b>Starter Unit</b>  <input type="checkbox"/> FSMS (+HWL) + E (finish)  <b>Example FSMS862448E</b></p> <p><b>Includes:</b>            1 starter frame kit            3* standard shelves            1 bottom shelf            4* standard wire covers with label holders            *54" includes on 2 shelves + 1 bottom shelf and 3 wire covers</p>	<p><b>Height</b></p> <p><input type="checkbox"/> 54" (3-Tier)  <input type="checkbox"/> 62" (4-Tier)  <input type="checkbox"/> 74" (4-Tier)  <input type="checkbox"/> 86" (4-Tier)</p>	<p><b>Width</b></p> <p><input type="checkbox"/> 18" <input type="checkbox"/> 21"  <input type="checkbox"/> 24" <input type="checkbox"/> 30"</p>	<p><b>Length</b></p> <p><input type="checkbox"/> 18" <input type="checkbox"/> 24"  <input type="checkbox"/> 30" <input type="checkbox"/> 36"  <input type="checkbox"/> 42" <input type="checkbox"/> 48"  <input type="checkbox"/> 54" <input type="checkbox"/> 60"</p>
<p><b>Add-On Unit</b>  <input type="checkbox"/> FSMA (+HWL) + E (finish)  <b>Example FSMA862448E</b></p> <p><b>Includes:</b>            1 Add-on Frame kit            3* standard shelves            1 bottom shelf            4* standard wire covers with label holders            *54" includes on 2 standard shelves + 1 bottom shelf and 3 wire covers</p>	<p><b>Height</b></p> <p><input type="checkbox"/> 54" (3-Tier)  <input type="checkbox"/> 62" (4-Tier)  <input type="checkbox"/> 74" (4-Tier)  <input type="checkbox"/> 86" (4-Tier)</p>	<p><b>Width</b></p> <p><input type="checkbox"/> 18" <input type="checkbox"/> 21"  <input type="checkbox"/> 24" <input type="checkbox"/> 30"</p>	<p><b>Length</b></p> <p><input type="checkbox"/> 18" <input type="checkbox"/> 24"  <input type="checkbox"/> 30" <input type="checkbox"/> 36"  <input type="checkbox"/> 42" <input type="checkbox"/> 48"  <input type="checkbox"/> 54" <input type="checkbox"/> 60"</p>
<p><b>Starter Frame Kit</b>  <input type="checkbox"/> FSF (+HWL) + E (finish)  <b>Example FSF742454E</b></p> <p><b>Includes:</b>            2 uprights            2 angle spreaders            1 cross brace assembly            1 hardware package</p>	<p><b>Height</b></p> <p><input type="checkbox"/> 34" <input type="checkbox"/> 54"  <input type="checkbox"/> 62" <input type="checkbox"/> 74"  <input type="checkbox"/> 86"</p>	<p><b>Width</b></p> <p><input type="checkbox"/> 18" <input type="checkbox"/> 21"  <input type="checkbox"/> 24" <input type="checkbox"/> 30"</p>	<p><b>Length</b></p> <p><input type="checkbox"/> 18" <input type="checkbox"/> 24"  <input type="checkbox"/> 30" <input type="checkbox"/> 36"  <input type="checkbox"/> 42" <input type="checkbox"/> 48"  <input type="checkbox"/> 54" <input type="checkbox"/> 60"</p>
<p><b>Add-On Frame Kit</b>  <input type="checkbox"/> FSFA (+HWL) + E (finish)  <b>Example FSFA741830E</b></p> <p><b>Includes:</b>            1 upright            2 angle spreaders            1 cross brace assembly            1 hardware package</p>	<p><b>Height</b></p> <p><input type="checkbox"/> 34" <input type="checkbox"/> 54"  <input type="checkbox"/> 62" <input type="checkbox"/> 74"  <input type="checkbox"/> 86"</p>	<p><b>Width</b></p> <p><input type="checkbox"/> 18" <input type="checkbox"/> 21"  <input type="checkbox"/> 24" <input type="checkbox"/> 30"</p>	<p><b>Length</b></p> <p><input type="checkbox"/> 18" <input type="checkbox"/> 24"  <input type="checkbox"/> 30" <input type="checkbox"/> 36"  <input type="checkbox"/> 42" <input type="checkbox"/> 48"  <input type="checkbox"/> 54" <input type="checkbox"/> 60"</p>

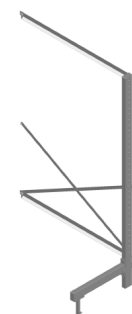
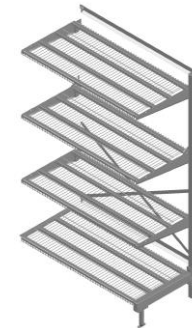
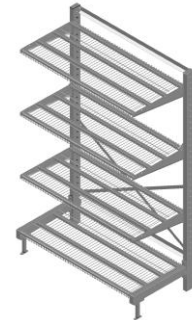

AMCO • Freestyle • ISS • Kelmax • LPI • Universal Stainless • Gillis-Jarke

# Freestyle™ Modular

## FREESTYLE REFERENCE DIMENSIONS



*Starter Unit Lengths*

Nominal Length	Actual Length
18	18.0625
24	24.0625
30	30.0625
36	36.0625
42	42.0625
48	48.0625
54	54.0625
60	60.0625

*Starter Unit Heights*

Nominal Height	Actual Height
54	56.125
62	64.125
74	76.125
86	88.125

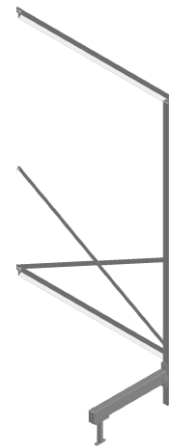

*Add-On Unit Lengths*

Nominal Length	Actual Length
18	15.8125
24	21.8125
30	27.8125
36	33.8125
42	39.8125
48	45.8125
54	51.8125
60	57.8125

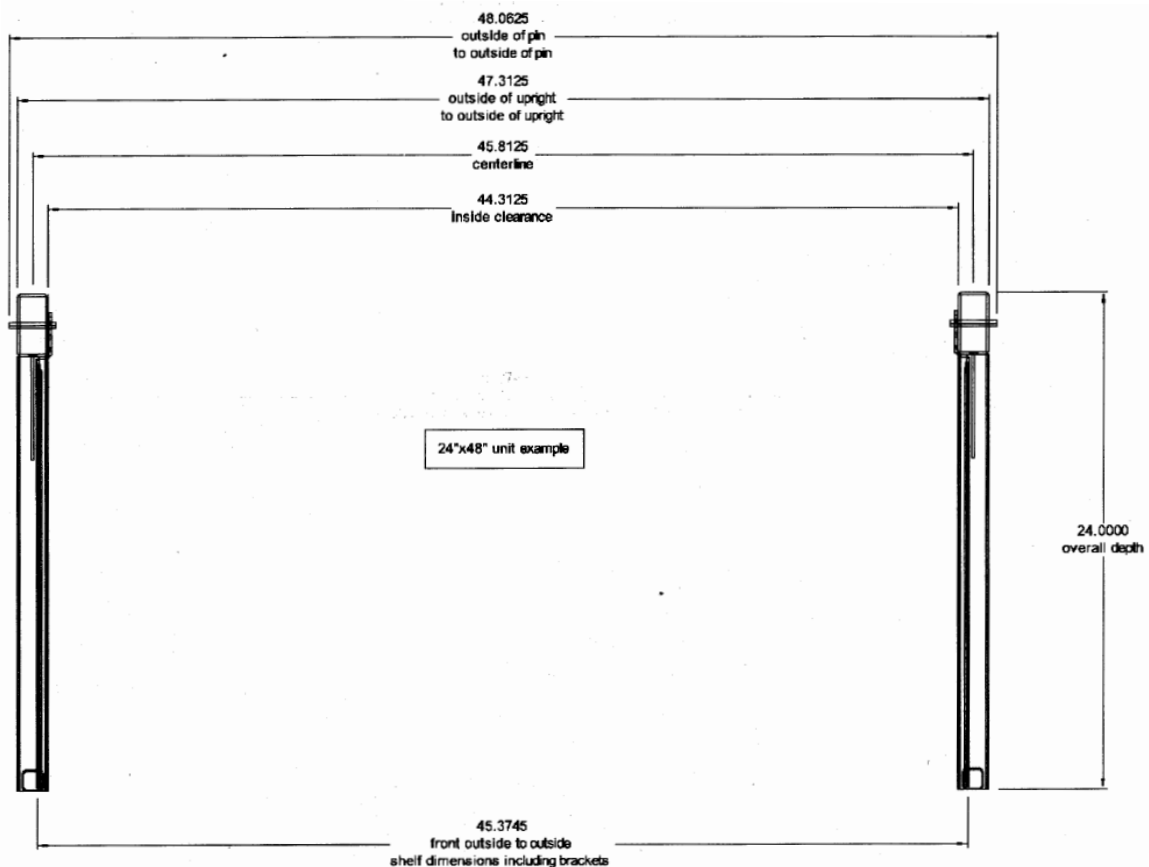

AMCO • Freestyle • ISS • Kelmax • LPI • Universal Stainless • Gillis-Jarke

SPG International, LLC  
11230 Harland Drive NE  
Covington, GA 30014  
877-503-4SPG (4774)

[www.spgusa.com](http://www.spgusa.com)

The best names in the business  
all have one thing in common.

EXPECT MORE  
**SPG**  
STORAGE PRODUCTS GROUP

# Freestyle™ Modular

## SPECIFICATIONS

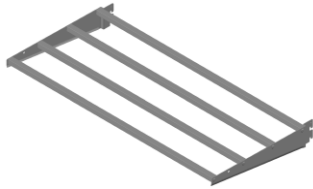

Standard Shelf

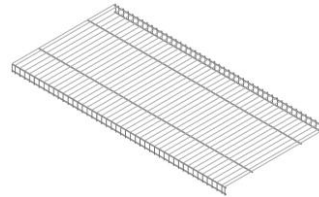

Wire Shelf Cover

Model No.*	W x L (in.)	(mm.)	Weight (lbs.)	(kg.)
<b>14" Width</b>				
FS1418E	14 X 18	356 x 457	5.82	2.64
FS1424E	14 X 24	356 x 610	6.97	3.16
FS1430E	14 X 30	356 x 762	8.12	3.68
FS1436E	14 X 36	356 x 914	9.27	4.20
FS1442E	14 X 42	356 x 1067	10.42	4.73
FS1448E	14 X 48	356 x 1219	11.57	5.25
FS1454E	14 X 54	356 x 1372	16.17	7.33
FS1460E	14 X 60	356 x 1524	17.7	8.03
<b>18" Width</b>				
FS1818E	18 X 18	457 x 457	6.5	2.95
FS1824E	18 X 24	457 x 610	7.65	3.47
FS1830E	18 X 30	457 x 762	8.8	3.99
FS1836E	18 X 36	457 x 914	9.95	4.51
FS1842E	18 X 42	457 x 1067	11.1	5.03
FS1848E	18 X 48	457 x 1219	12.25	5.56
FS1854E	18 X 54	457 x 1372	16.85	7.64
FS1860E	18 X 60	457 x 1524	18.38	8.34
<b>21" Width</b>				
FS2118E	21 X 18	533 x 457	7.01	3.18
FS2124E	21 X 24	533 x 610	8.16	3.70
FS2130E	21 X 30	533 x 762	9.31	4.22
FS2136E	21 X 36	533 x 914	10.46	4.74
FS2142E	21 X 42	533 x 1067	11.61	5.27
FS2148E	21 X 48	533 x 1219	12.76	5.79
FS2154E	21 X 54	533 x 1372	17.36	7.87
FS2160E	21 X 60	533 x 1524	18.89	8.57
<b>24" Width</b>				
FS2418E	24 X 18	610 x 457	8.67	3.93
FS2424E	24 X 24	610 x 610	10.2	4.63
FS2430E	24 X 30	610 x 762	11.74	5.33
FS2436E	24 X 36	610 x 914	13.27	6.02
FS2442E	24 X 42	610 x 1067	14.8	6.71
FS2448E	24 X 48	610 x 1219	16.33	7.41
FS2454E	24 X 54	610 x 1372	17.87	8.11
FS2460E	24 X 60	610 x 1524	19.4	8.80
<b>30" Width</b>				
FS3018E	30 X 18	762 x 457	9.69	4.40
FS3024E	30 X 24	762 x 610	11.22	5.09
FS3030E	30 X 30	762 x 762	12.76	5.79
FS3036E	30 X 36	762 x 914	14.29	6.48
FS3042E	30 X 42	762 x 1067	15.82	7.18
FS3048E	30 X 48	762 x 1219	17.35	7.87
FS3054E	30 X 54	762 x 1372	18.88	8.56
FS3055E	30 X 60	762 x 1524	20.42	9.26

Model No.*	W x L (in.)	(mm.)	Weight (lbs.)	(kg.)
<b>14" Width</b>				
FSCW1418E	14 X 18	356 x 457	2.23	1.01
FSCW1424E	14 X 24	356 x 610	3.05	1.38
FSCW1430E	14 X 30	356 x 762	3.87	1.76
FSCW1436E	14 X 36	356 x 914	4.75	2.15
FSCW1442E	14 X 42	356 x 1067	5.57	2.53
FSCW1448E	14 X 48	356 x 1219	6.46	2.93
FSCW1454E	14 X 54	356 x 1372	7.21	3.27
FSCW1460E	14 X 60	356 x 1524	8.03	3.64
<b>18" Width</b>				
FSCW1818E	18 X 18	457 x 457	2.91	1.32
FSCW1824E	18 X 24	457 x 610	3.42	1.55
FSCW1830E	18 X 30	457 x 762	3.93	1.78
FSCW1836E	18 X 36	457 x 914	4.53	2.05
FSCW1842E	18 X 42	457 x 1067	5.04	2.29
FSCW1848E	18 X 48	457 x 1219	5.55	2.52
FSCW1854E	18 X 54	457 x 1372	6.06	2.75
FSCW1860E	18 X 60	457 x 1524	6.57	2.98
<b>21" Width</b>				
FSCW2118E	21 X 18	533 x 457	3.12	1.42
FSCW2124E	21 X 24	533 x 610	3.7	1.68
FSCW2130E	21 X 30	533 x 762	4.28	1.94
FSCW2136E	21 X 36	533 x 914	4.97	2.25
FSCW2142E	21 X 42	533 x 1067	5.55	2.52
FSCW2148E	21 X 48	533 x 1219	6.13	2.78
FSCW2154E	21 X 54	533 x 1372	6.72	3.05
FSCW2160E	21 X 60	533 x 1524	7.3	3.31
<b>24" Width</b>				
FSCW2418E	24 X 18	610 x 457	3.32	1.51
FSCW2424E	24 X 24	610 x 610	4	1.81
FSCW2430E	24 X 30	610 x 762	4.64	2.10
FSCW2436E	24 X 36	610 x 914	5.4	2.45
FSCW2442E	24 X 42	610 x 1067	6.06	2.75
FSCW2448E	24 X 48	610 x 1219	6.72	3.05
FSCW2454E	24 X 54	610 x 1372	7.37	3.34
FSCW2460E	24 X 60	610 x 1524	8.03	3.64
<b>30" Width</b>				
FSCW3018E	30 X 18	762 x 457	3.74	1.70
FSCW3024E	30 X 24	762 x 610	4.5	2.04
FSCW3030E	30 X 30	762 x 762	5.34	2.42
FSCW3036E	30 X 36	762 x 914	6.28	2.85
FSCW3042E	30 X 42	762 x 1067	7.08	3.21
FSCW3048E	30 X 48	762 x 1219	7.89	3.58
FSCW3054E	30 X 54	762 x 1372	8.69	3.94
FSCW3060E	30 X 60	762 x 1524	9.49	4.30

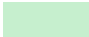
 : May require additional lead time

AMCO • Freestyle • ISS • Kelmax • LPI • Universal Stainless • Gillis-Jarke

SPG International, LLC  
11230 Harland Drive NE  
Covington, GA 30014  
877-503-4SPG (4774)

www.spgusa.com

The best names in the business  
all have one thing in common.

EXPECT MORE  
**SPG**  
STORAGE PRODUCTS GROUP

# Freestyle™ Modular

## SPECIFICATIONS

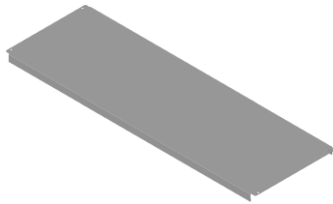

**Solid  
Shelf Cover**



**Bottom  
Shelf**

Model No.*	W x L (in.)	(mm.)	Weight (lbs.)	(kg.)
<b>14" Width</b>				
FSCS1418S	14 X 18	356 x 457	5.35	2.43
FSCS1424S	14 X 24	356 x 610	6.88	3.12
FSCS1430S	14 X 30	356 x 762	8.41	3.81
FSCS1436S	14 X 36	356 x 914	9.93	4.50
FSCS1442S	14 X 42	356 x 1067	11.46	5.20
FSCS1448S	14 X 48	356 x 1219	13	5.90
FSCS1454S	14 X 54	356 x 1372	14.52	6.59
FSCS1460S	14 X 60	356 x 1524	16.05	7.28
<b>18" Width</b>				
FSCS1818S	18 X 18	457 x 457	6.78	3.08
FSCS1824S	18 X 24	457 x 610	8.71	3.95
FSCS1830S	18 X 30	457 x 762	10.65	4.83
FSCS1836S	18 X 36	457 x 914	12.58	5.71
FSCS1842S	18 X 42	457 x 1067	14.52	6.59
FSCS1848S	18 X 48	457 x 1219	16.45	7.46
FSCS1854S	18 X 54	457 x 1372	18.39	8.34
FSCS1860S	18 X 60	457 x 1524	20.33	9.22
<b>21" Width</b>				
FSCS2118S	21 X 18	533 x 457	7.84	3.56
FSCS2124S	21 X 24	533 x 610	10.09	4.58
FSCS2130S	21 X 30	533 x 762	12.33	5.59
FSCS2136S	21 X 36	533 x 914	14.57	6.61
FSCS2142S	21 X 42	533 x 1067	16.81	7.62
FSCS2148S	21 X 48	533 x 1219	19.05	8.64
FSCS2154S	21 X 54	533 x 1372	21.29	9.66
FSCS2160S	21 X 60	533 x 1524	23.53	10.67
<b>24" Width</b>				
FSCS2418S	24 X 18	610 x 457	8.91	4.04
FSCS2424S	24 X 24	610 x 610	10	4.54
FSCS2430S	24 X 30	610 x 762	14.01	6.35
FSCS2436S	24 X 36	610 x 914	16.56	7.51
FSCS2442S	24 X 42	610 x 1067	19.1	8.66
FSCS2448S	24 X 48	610 x 1219	21.65	9.82
FSCS2454S	24 X 54	610 x 1372	24.2	10.98
FSCS2460S	24 X 60	610 x 1524	26.74	12.13
<b>30" Width</b>				
FSCS3018S	30 X 18	762 x 457	11.05	5.01
FSCS3024S	30 X 24	762 x 610	14.21	6.45
FSCS3030S	30 X 30	762 x 762	17.37	7.88
FSCS3036S	30 X 36	762 x 914	20.53	9.31
FSCS3042S	30 X 42	762 x 1067	23.69	10.75
FSCS3048S	30 X 48	762 x 1219	26.85	12.18
FSCS3054S	30 X 54	762 x 1372	30	13.61
FSCS3060S	30 X 60	762 x 1524	33.16	15.04

Model No.*	W x L (in.)	(mm.)	Weight (lbs.)	(kg.)
<b>18" Width</b>				
FSB1818E	18 X 18	457 x 457	6.83	3.10
FSB1824E	18 X 24	457 x 610	8.63	3.91
FSB1830E	18 X 30	457 x 762	9.89	4.49
FSB1836E	18 X 36	457 x 914	11.42	5.18
FSB1842E	18 X 42	457 x 1067	12.95	5.87
FSB1848E	18 X 48	457 x 1219	14.49	6.57
FSB1854E	18 X 54	457 x 1372	19.47	8.83
FSB1860E	18 X 60	457 x 1524	21.38	9.70
<b>21" Width</b>				
FSB2118E	21 X 18	533 x 457	7.2	3.27
FSB2124E	21 X 24	533 x 610	8.73	3.96
FSB2130E	21 X 30	533 x 762	10.26	4.65
FSB2136E	21 X 36	533 x 914	11.79	5.35
FSB2142E	21 X 42	533 x 1067	13.33	6.05
FSB2148E	21 X 48	533 x 1219	14.86	6.74
FSB2154E	21 X 54	533 x 1372	19.84	9.00
FSB2160E	21 X 60	533 x 1524	21.75	9.87
<b>24" Width</b>				
FSB2418E	24 X 18	610 x 457	7.57	3.43
FSB2424E	24 X 24	610 x 610	9.1	4.13
FSB2430E	24 X 30	610 x 762	10.63	4.82
FSB2436E	24 X 36	610 x 914	12.17	5.52
FSB2442E	24 X 42	610 x 1067	13.7	6.21
FSB2448E	24 X 48	610 x 1219	15.23	6.91
FSB2454E	24 X 54	610 x 1372	20.21	9.17
FSB2460E	24 X 60	610 x 1524	22.12	10.03
<b>30" Width</b>				
FSB3018E	30 X 18	762 x 457	7.57	3.43
FSB3024E	30 X 24	762 x 610	9.1	4.13
FSB3030E	30 X 30	762 x 762	10.63	4.82
FSB3036E	30 X 36	762 x 914	12.17	5.52
FSB3042E	30 X 42	762 x 1067	13.7	6.21
FSB3048E	30 X 48	762 x 1219	15.23	6.91
FSB3054E	30 X 54	762 x 1372	20.21	9.17
FSB3060E	30 X 60	762 x 1524	22.12	10.03

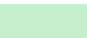
 : May require additional lead time

AMCO • Freestyle • ISS • Kelmax • LPI • Universal Stainless • Gillis-Jarke

SPG International, LLC  
11230 Harland Drive NE  
Covington, GA 30014  
877-503-4SPG (4774)

www.spgusa.com

The best names in the business  
all have one thing in common.

EXPECT MORE  
**SPG**  
STORAGE PRODUCTS GROUP

# Freestyle™ Modular

## SPECIFICATIONS



### Freestyle Starter Station

- ◆ A place for everything and everything in it's place — the ergonomic design maximizes usable kitchen space and provides added storage for packaging, smallwares, menus, ingredients, utensils and more.
- ◆ Built for performance and durability — with an impressive total load-bearing capacity of 2,800 lbs.
- ◆ Adapts quickly and easily to accommodate steamers, microwaves, refrigeration units and other standard equipment for fast menu changes
- ◆ Fast, easy cleaning of all surfaces.

Model No.*	W x L x H	
	(in.)	(mm.)
WST1491E	30 x 60 x 86	762 x 1524 x 2184
WST1539E	30 x 54 x 86	762 x 1372 x 2184
WST1492E	30 x 48 x 86	762 x 1219 x 2184
WST1493E	30 x 36 x 86	762 x 914 x 2184

See Accessories to customize your station for prep, drive-thru, and general workstations.

Prep Surface Widths	Overhead Shelf Widths	Lengths	Inside Clearance
<input type="checkbox"/> 30" 762 mm	<input type="checkbox"/> 18" 457 mm	<input type="checkbox"/> 36" 914 mm	<input type="checkbox"/> 32.25" 819 mm
		<input type="checkbox"/> 48" 1219 mm	<input type="checkbox"/> 44.25" 1124 mm
		<input type="checkbox"/> 54" 1372 mm	<input type="checkbox"/> 56.25" 1429 mm
		<input type="checkbox"/> 60" 1524 mm	



AMCO • Freestyle • ISS • Kelmax • LPI • Universal Stainless • Gillis-Jarke

SPG International, LLC  
11230 Harland Drive NE  
Covington, GA 30014  
877-503-4SPG (4774)

www.spgusa.com

The best names in the business  
all have one thing in common.

EXPECT MORE  
**SPG**  
STORAGE PRODUCTS GROUP

# Freestyle™ Modular

## FREESTYLE REINFORCEMENT BRACE



### The New Freestyle™ Brace

*A Simple Design That Creates Extraordinary Strength.*

*The new Freestyle™ Brace significantly increases load capacities — making it the ideal solution for heavyweight products both on the sales floor or in the back room.*

An engineering feat doesn't have to be complicated or costly to make a dramatic impact on performance and functionality. In fact, what is most impressive about the best engineering solutions is how simply and elegantly they create value. That is certainly the case with the new patent pending brace SPG developed for Freestyle™ shelving.

When you take a look at the brace, it certainly doesn't seem to be an amazing piece of engineering — it's only after you become aware of the added performance it provides that you begin to appreciate its ingenuity. Already recognized as the industry's most innovative and versatile shelving, Freestyle strength is significantly increased by this simple device. In fact, the new Freestyle brace increases load capacities by:

- ◆ 25% on 30-in. shelves — from 600 lbs. to 800 lbs.
- ◆ 40% on 24-in. shelves — to 1,000 lbs.

That results in an increase in overall unit weight capacity of up to 30% — and provides the additional strength critical for the storage and display of heavy, high-density products.

Just as importantly, the new brace achieves this additional weight capacity without sacrificing any shelf space whatsoever — and its low profile design and placement make it virtually invisible.

- ◆ The brace fits all Freestyle shelf depths and lengths
- ◆ Installation is fast, easy and requires no tools
- ◆ It doesn't interfere with the repositioning of shelving — Freestyle retains its convenience and all of its display and storage adaptability
- ◆ The brace significantly increases the weight and capacity of your shelving

The new brace is available now as a retrofit for existing units, or as an option on new Freestyle shelving — contact your SPG sales rep to order.

AMCO • Freestyle • ISS • Kelmax • LPI • Universal Stainless • Gillis-Jarke

SPG International, LLC  
11230 Harland Drive NE  
Covington, GA 30014  
877-503-4SPG (4774)

[www.spgusa.com](http://www.spgusa.com)

The best names in the business  
all have one thing in common.

EXPECT MORE  
**SPG**  
STORAGE PRODUCTS GROUP

# Freestyle™ Modular

## SPECIFICATIONS

Freestanding modular cantilevered shelving system with adjustable shelves. Fully expandable side-to-side using common uprights with dual-side adjustment. Durable heavy-duty steel construction and NSF certified.

Shelves cantilever off modular frame consisting of main rear upright column and modular leg kit, integrated with bracing kit for total unit support and stability. One-piece cantilever shelves with 2" increment adjustability are insertable starting at floor-to-shelf surface height of 15". Stationary bottom shelf installs at 9" above floor or may be removed for open base applications.

Shelf constructed from 11 gauge reinforced brackets welded to 16 gauge tubular runners. Uprights are tubular construction consisting of 16 gauge front leg and 11 gauge horizontal upright extension with safety strap, bolted to 11 gauge column with adjustment pins. Shelves, uprights and frame kit have rust-resistant powder-coated finish with advanced antimicrobial protective agent.

Shelves available in 5 widths (14", 18", 21", 24", 30") and 8 lengths (18", 24", 30", 36", 42", 48", 54", 60"). Uprights available in 5 heights (34", 54", 62", 74", 86"). A complete assortment of available accessories for complete customization — including hanger rails, and shelf covers (powder-coated wire and solid stainless steel material).

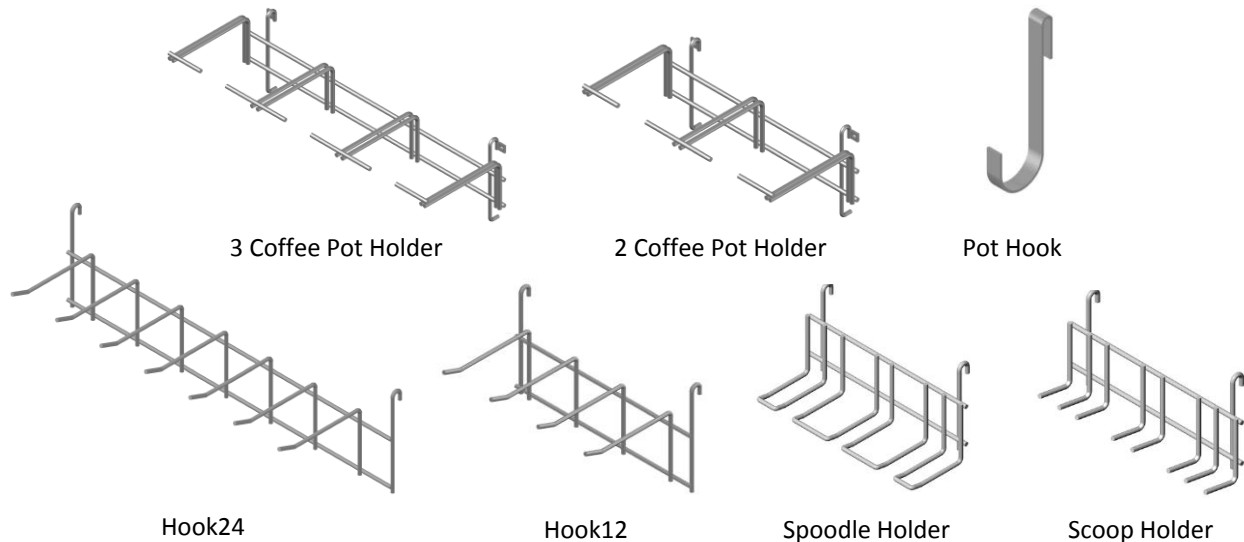

Model No.*	Description	W x L		Weight	
		(in.)	(mm.)	(lbs.)	(kg.)
HOOK24E	24" Hook with seven 6" prongs	7 x 23 3/4 x 6 1/2	182 x 603 x 165	1.75	0.79
HOOK12E	12" Hook with four 6" prongs	7 x 12 x 6 1/2	182 x 305 x 165	1	0.45
GRSPOODE	Spoodle Holder	3 x 10	76 x 254	1	0.45
GRSCOPE	Scoop Holder	5 x 10	127 x 257	1.25	0.57
COFF2E	2 Coffee Pot Holder	6 x 5 5/8 x 20 1/8	153 x 143 x 511	2.8	1.27
COFF3E	3 Coffee Pot Holder	6 x 5 5/8 x 13 1/2	153 x 143 x 343	2.5	1.13
PHKE	Pot Hook				

AMCO • Freestyle • ISS • Kelmax • LPI • Universal Stainless • Gillis-Jarke

SPG International, LLC  
11230 Harland Drive NE  
Covington, GA 30014  
877-503-4SPG (4774)

www.spgusa.com

The best names in the business  
all have one thing in common.

EXPECT MORE  
**SPG**  
STORAGE PRODUCTS GROUP



# Freestyle™ Modular

## ACCESSORIES

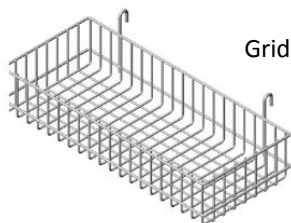

Grid Baskets

Model No.*	W x L		Weight	
	(in.)	(mm.)	(lbs.)	(kg.)
GB12246E	12 x 24 x 6	305 x 610 x 150	3 3/4	1.70
GB12186E	12 x 18 x 6	305 x 457 x 150	3	1.36
GB18143E	18 x 14 x 3	457 x 355 x 76	3	1.36
GBSPRINKE	5 x 12 x 4	126 x 305 x 102	1	0.45
GB4418R1E	4 x 4 x 18	102 x 102 x 457	1 1/2	0.68
GB12106E	12 x 10 x 6	305 x 254 x 150	2 1/2	1.13

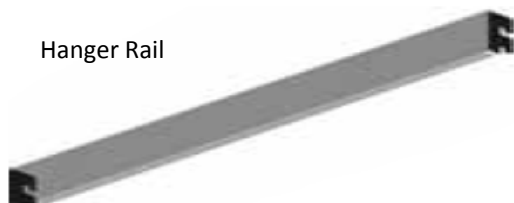

Hanger Rail

Model No.*	W x L		Weight	
	(in.)	(mm.)	(lbs.)	(kg.)
FSHR18E	18	457	3.02	1.37
FSHR24E	24	610	4.03	1.83
FSHR30E	30	762	5.04	2.29
FSHR36E	36	914	6.05	2.74
FSHR42E	42	1067	7.06	3.20
FSHR48E	48	1219	8.07	3.66
FSHR49E	54	1372	9.07	4.11
FSHR50E	60	1524	10.08	4.57

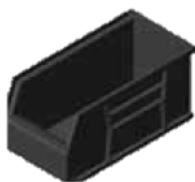

Bins

Model No.*	Color	L x W x H		Weight	
		(in.)	(mm.)	(lbs.)	(kg.)
ISS30230B	Blue	11 x 5 1/2 x 5	279 x 140 x 127	0.6	0.3
ISS30230E	Grey	11 x 5 1/2 x 5	279 x 140 x 127	0.6	0.3
ISS30235B	Blue	11 x 11 x 5	279 x 279 x 127	0.9	0.4
ISS30235E	Grey	11 x 11 x 5	279 x 279 x 127	0.9	0.4
ISS30240B	Blue	14 3/4 x 8 1/4 x 7	375 x 210 x 178	1.4	0.6
ISS30250B	Blue	14 3/4 x 16 1/2 x 7	375 x 419 x 178	2.3	1.1
ISS30128R	Red	17 3/4 x 4 1/8 x 4	451 x 105 x 102	0.5	0.2



Condiment Bins

Model No.*	W x L x H		Weight	
	(in.)	(mm.)	(lbs.)	(kg.)
Single Condiment Bin				
DT3BINE	15 x 4 3/4 x 14 1/2	381 x 121 x 368	2 1/4	1.00
Condiment Bin Frame - Holds Two Bins				
CBF2E	15 x 10 x 14 1/2	381 x 254 x 368	6	2.70
Condiment Bin Frame - Holds Three Bins				
CBF3E	15 x 14 x 14 1/2	381 x 356 x 368	8	3.6
5 Bin Wall Mounting Kit				
WST594E	25 x 48 1/2 x 8	635 x 1232 x 203	20	9

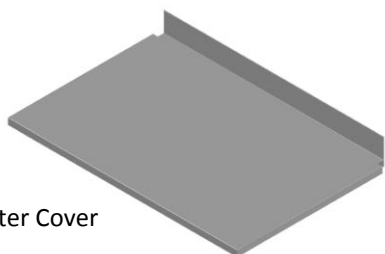

Counter Cover

Model No.*	W x L		Weight	
	(in.)	(mm.)	(lbs.)	(kg.)
With Backsplash				
FSCC3030BS4S	30 x 30	762 x 762	22.97	10.41
FSCC3036BS4S	30 x 36	762 x 914	26.34	11.93
FSCC3042BS4S	30 x 42	762 x 1067	29.7	13.46
FSCC3048BS4S	30 x 48	762 x 1219	33.06	14.98
FSCC3054BS4S	30 x 54	762 x 1372	36.42	16.5
FSCC3060BS4S	30 x 60	762 x 1524	39.78	18.02



AMCO • Freestyle • ISS • Kelmax • LPI • Universal Stainless • Gillis-Jarke

SPG International, LLC  
11230 Harland Drive NE  
Covington, GA 30014  
877-503-4SPG (4774)

www.spgusa.com

The best names in the business  
all have one thing in common.

EXPECT MORE  
**SPG**  
STORAGE PRODUCTS GROUP